

## KLEMENSLER

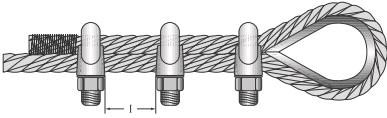

### Uygulamalar:

Çelik halatlarda soketleme, yapıştırma ve preslemenin mümkün olmadığı veya geçici bağlantının gerekli olduğu durumlarda kullanılan bağlantı elemanıdır.



- ★ Tanıtıcı ölçüleri okunaklı olmalıdır.
- ★ Üzerinde herhangi bir çatlak, kırık ve oyuk olmamalıdır.
- ★ Kullanılacak halat çapına uygun ölçülerde klemens seçilmelidir.
- ★ Herhangi bir ısıtma işlemine tabi tutulmamalıdır.
- ★ Halat klemens ile sonlandırıldığında görseldeki gibi bağlantı yapılmalıdır.

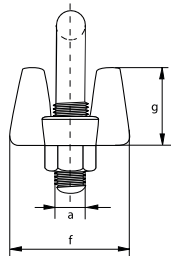
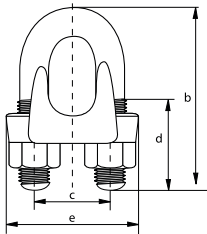

## A TİPİ

Ölçü (mm)	a (mm)	b (mm)	c (mm)	d (mm)	e (mm)	f (mm)	g (mm)
6,00	5,00	24,0	12,0	14,0	23,0	17,0	14,0
8,00	6,00	30,0	15,0	16,0	28,0	21,0	17,0
10,0	8,00	37,0	19,0	20,0	38,0	28,0	21,0
12,0	10,0	47,0	24,0	25,0	45,0	34,0	27,0
15,0	12,0	56,0	29,0	30,0	52,0	40,0	32,0
20,0	14,0	70,0	36,0	36,0	62,0	47,0	38,0
22,0	16,0	77,0	40,0	39,0	69,0	52,0	43,0
25,0	18,0	85,0	43,0	44,0	76,0	56,0	50,0
28,0	20,0	95,0	48,0	48,0	85,0	62,0	57,0
32,0	22,0	108	55,0	51,0	93,0	67,0	61,0
40,0	24,0	120	64,0	62,0	110	81,0	73,0
45,0	27,0	137	72,0	70,0	123	88,0	86,0
50,0	30,0	154	80,0	80,0	135	95,0	95,0

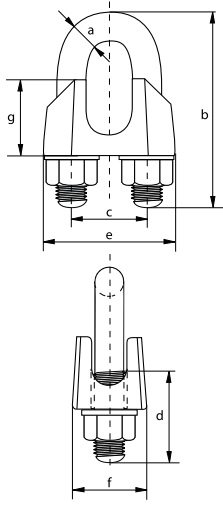

## DIN 1142

Ölçü (mm)	a (mm)	b (mm)	c (mm)	d (mm)	e (mm)	f (mm)	g (mm)
5,00	5,00	25,0	12,0	14,0	25,0	13,0	13,0
6,50	6,00	32,0	14,0	17,0	30,0	16,0	14,0
8,00	8,00	41,0	18,0	20,0	39,0	20,0	18,0
10,0	8,00	46,0	20,0	24,0	40,0	20,0	21,0
13,0	12,0	64,0	29,0	30,0	55,0	28,0	29,0
16,0	14,0	76,0	34,0	35,0	64,0	32,0	35,0
19,0	14,0	83,0	37,0	36,0	68,0	32,0	40,0
22,0	16,0	96,0	41,0	40,0	74,0	34,0	44,0
26,0	20,0	111	46,0	50,0	84,0	38,0	51,0
30,0	20,0	127	54,0	55,0	95,0	41,0	59,0
34,0	22,0	141	60,0	60,0	105	45,0	67,0
40,0	24,0	159	68,0	65,0	117	49,0	77,0

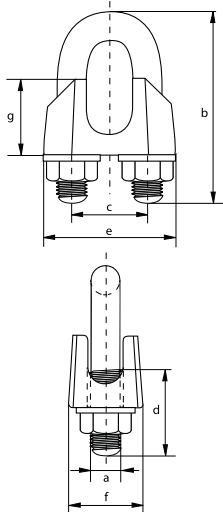

## DIN 741

Ölçü (mm)	a (mm)	b (mm)	c (mm)	d (mm)	e (mm)	f (mm)	g (mm)
3,00	4,00	20,0	9,00	12,0	21,0	10,0	10,0
5,00	5,00	24,0	11,0	13,0	23,0	11,0	10,0
6,00	5,00	28,0	13,0	15,0	26,0	12,0	11,0
8,00	6,00	34,0	16,0	19,0	30,0	14,0	15,0
10,0	8,00	42,0	19,0	22,0	34,0	18,0	17,0
11,0	8,00	44,0	20,0	22,0	36,0	19,0	18,0
13,0	10,0	55,0	24,0	30,0	42,0	23,0	21,0
14,0	10,0	57,0	25,0	30,0	44,0	23,0	22,0
16,0	12,0	63,0	29,0	33,0	50,0	26,0	26,0
19,0	12,0	75,0	32,0	38,0	54,0	29,0	30,0
22,0	14,0	85,0	37,0	44,0	61,0	33,0	34,0
26,0	14,0	95,0	41,0	45,0	65,0	35,0	37,0
30,0	16,0	110	48,0	50,0	74,0	37,0	43,0
34,0	16,0	120	52,0	55,0	80,0	42,0	50,0
40,0	16,0	140	58,0	60,0	88,0	45,0	55,0
45,0	18,0	163	65,0	75,0	97,0	49,0	60,0
50,0	20,0	170	72,0	77,0	106	51,0	65,0

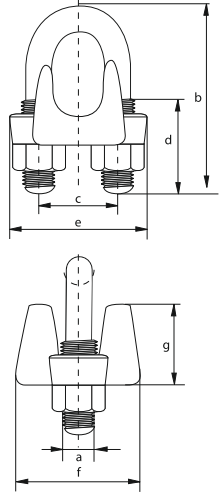
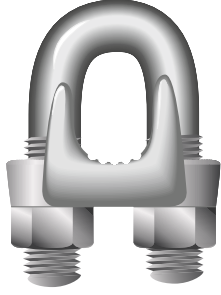

## XL TİPİ

Ölçü (mm)	a (mm)	b (mm)	c (mm)	d (mm)	e (mm)	f (mm)	g (mm)
4,00	5,00	24,0	12,0	11,0	24,0	21,0	10,0
5,00	6,00	31,0	15,0	13,0	29,0	24,0	13,0
7,00	8,00	34,0	19,0	13,0	37,0	30,0	18,0
8,00	10,0	45,0	22,0	19,0	43,0	33,0	19,0
10,0	11,0	49,0	26,0	19,0	49,0	42,0	25,0
11,0	12,0	60,0	30,0	25,0	58,0	46,0	26,0
15,0	14,0	72,0	33,0	32,0	63,0	52,0	31,0
16,0	14,0	74,0	33,0	32,0	64,0	54,0	36,0
20,0	16,0	86,0	38,0	37,0	72,0	57,0	38,0
22,0	19,0	98,0	45,0	41,0	80,0	62,0	40,0
30,0	19,0	117	51,0	51,0	91,0	73,0	48,0
36,0	22,0	140	60,0	59,0	108	79,0	58,0
40,0	22,0	147	66,0	60,0	112	85,0	64,0
42,0	25,0	161	70,0	67,0	121	92,0	67,0
46,0	29,0	174	78,0	70,0	134	97,0	76,0
52,0	32,0	195	86,0	78,0	150	113	85,0

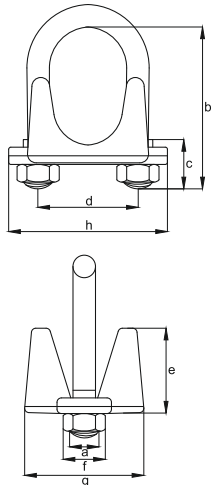

## CROSBY G-450

Ölçü		a (mm)	b (mm)	c (mm)	d (mm)	e (mm)	f (mm)	g (mm)	h (mm)
(mm)	(inç)								
3 - 4	1/8	5,60	18,3	11,2	11,9	10,4	9,65	20,6	23,9
5	3/16	6,35	24,6	14,2	15,0	12,7	11,2	23,9	29,5
6 - 7	1/4	7,85	26,2	12,7	19,1	16,8	14,2	30,2	36,6
8	5/16	9,65	35,1	19,1	22,4	18,3	17,5	33,3	42,9
9 - 10	3/8	11,2	38,1	19,1	25,4	23,1	19,1	41,4	49,3
11	7/16	12,7	47,8	25,4	30,2	26,2	22,4	46,0	58,0
12 - 13	1/2	12,7	47,8	25,4	30,2	28,7	22,4	48,5	58,0
14 - 15	9/16	14,2	57,0	31,8	33,3	31,0	23,9	52,5	63,5
16	5/8	14,2	60,5	31,8	33,3	34,0	23,9	52,5	63,5
18 - 20	3/4	15,7	70,0	36,6	38,1	35,8	26,9	57,0	72,0
22	7/8	19,1	79,0	41,1	44,5	40,4	31,8	62,0	80,5
24 - 26	1	19,1	89,0	46,0	47,8	45,2	31,8	67,0	88,0
28 - 30	1 1/8	19,1	98,5	51,0	51,0	48,5	31,8	71,5	91,0
32 - 34	1 1/4	22,4	108	54,0	59,4	55,5	36,6	79,5	105
36	1 3/8	22,4	118	58,5	59,4	58,5	36,6	79,5	106
38	1 1/2	22,4	125	60,5	66,5	62,0	36,6	86,5	113
41 - 42	1 5/8	25,4	135	66,5	70,0	67,5	41,4	92,0	121
44 - 46	1 3/4	28,7	146	70,0	77,5	74,5	46,0	97,0	134
48 - 52	2	31,8	164	76,0	86,0	77,0	51,0	113	149



## CROSBY G-429

Ölçü		c (mm)	d (mm)	e (mm)	g (mm)	n (mm)
(mm)	(inc)					
5 - 7	3/16 - 1/4	10,2	23,9	9,65	32,5	36,6
8	5/16	11,9	26,9	9,65	37,3	39,1
10	3/8	13,0	26,9	11,2	46,0	45,2
11 - 13	7/16 - 1/2	15,0	31,8	12,7	55,5	54,6
14 - 16	9/16 - 5/8	18,3	38,1	16,0	68,5	65,3
18 - 20	3/4	21,8	46,0	19,1	74,5	67,8
22	7/8	24,6	53,8	19,1	84,0	72,6
24 - 26	1	28,7	57,0	19,1	94,5	77,7
28 - 30	1 1/8	32,5	60,5	22,4	107	87,4
32 - 34	1 1/4	34,0	63,5	22,4	108	90,4
36 - 40	1 3/8 - 1 1/2	39,6	76,0	25,4	141	105

